

5200 SERIES PLANE SWIVEL JOINTS

The direct method to handle single and multi-plane swivel movement with positive sealing between piping system elements.

Threaded Ends

Available in:
all steel
all stainless steel
combination carbon steel outer casting with stainless steel parts in contact with fluids.

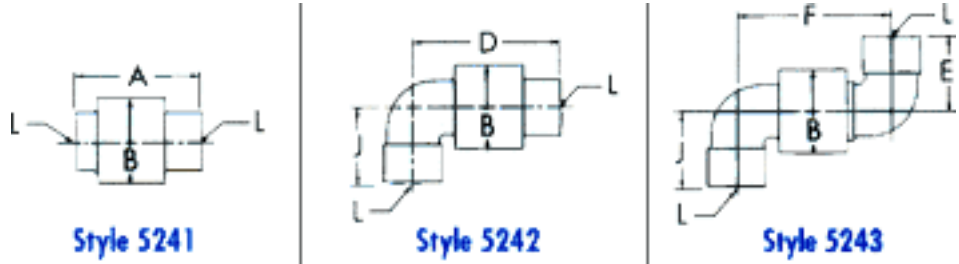

Basic Assembly Number
Steel
All Stainless Steel
* Comb. Carbon Steel and Stainless

BD52410
BD52411
BD52412

BD52420
BD52421
BD52422

BD52430
BD52431
BD52432

*All metal parts in contact with fluid are stainless steel. Outer casing is carbon steel.
Available in 2" and 3" sizes only, on special order.
Note: BSP threads are available.

Dimension Data - in./mm



Joint Size	A	B	D	E	F	J	Pipe Thread L	Maximum cold working pressure psi(kg/cm ²)
1" 25mm	4.19 106	2.50 64	4.38 111	2.50 64	4.59 117	2.50 64	1"	1250 88
1 1/2" 40mm	4.62 117	3.25 83	5.06 128	3.25 83	5.50 140	3.25 83	1 1/2"	1000 70
2" 50mm	5.88 149	4.00 102	6.81 173	3.50 89	7.50 191	3.69 94	2"	1000 70
3" 75mm	6.88 175	5.62 143	7.25 184	4.69 119	8.40 213	4.69 119	3"	1000 70

Welded Ends

Available in:
all steel
all stainless steel
combination carbon steel outer casting with stainless steel parts in contact with fluids.



Basic Assembly Number
Steel
All Stainless Steel
Comb. Carbon Steel and Stainless

BD51410
BD51411
BD51412

BD51420
BD51421
BD51422

BD51430
BD51431
BD51432

*All metal parts in contact with fluid are stainless steel. Outer casing is carbon steel.
Available in 2" and 3" sizes only, on special order.
Note: BSP threads are available.

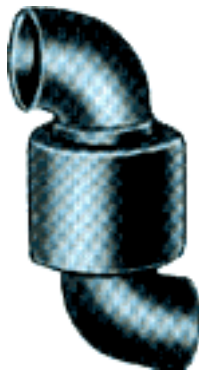

Dimension Data - in./mm

Joint Size	A	B	D	E	F	Maximum cold working pressure psi(kg/cm ²)
3" 75mm	12.88 327	5.50 140	11.95 304	3.00 76	10.88 276	1000 70
4" 100mm	13.22 326	7.00 178	13.22 326	4.00 102	13.22 326	1000 70
6" 150mm	16.75 425	9.00 229	18.75 476	6.00 152	20.75 527	750 53

Flanged Ends

Available in:

all steel

all stainless steel

combination carbon steel outer casting with stainless steel parts in contact with fluids.

ANSI 150 lb. flange rated. Contact BARCO for higher rated flanges.

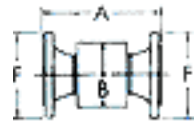

Style 5241

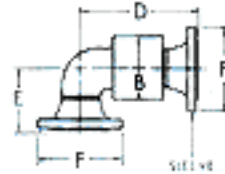

Style 5242

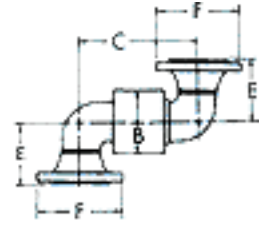

Style 5243

Basic Assembly Number
Steel

All Stainless Steel

Comb. Carbon Steel and Stainless

BD53410
BD53411
BD53412

BD53420
BD53421
BD53422

BD53430
BD53431
BD53432

*All metal parts in contact with fluid are stainless steel. Outer casing is carbon steel.

Available in 2" and 3" sizes only, on special order.

Note: Style 5347 - similar to Style 5242 except with 90° sleeve and straight retainer can be furnished, consult BARCO for availability.

Dimension Data - in./mm



Joint Size	A	B	C	D	E	F	Maximum cold working pressure psi(kg/cm ²)*
3" 75mm	10.38 264	5.50 140	10.95 278	10.70 272	5.75 146	7.50 190	275 19
4" 100mm	11.22 285	7.00 178	13.22 336	12.47 318	7.12 181	9.00 229	275 19
6" 150mm	15.75 400	9.00 229	20.75 527	18.75 476	9.50 241	11.00 279	275 19

**Use ANSI 150 lb. flange pressure-temperature ratings for temperatures over +100° F (37.5°).

5200 Series High Temperature Plane Swivel Joints

5200 Series High Temperature Plane Swivel Joints can safely handle steam, hot water, heat transfer oils and other difficult to seal fluids. These joints feature flaked graphite rechargeable seals.

- Typical applications: soot blowers, black liquor applications in pulp and paper industry, heat transfer oils in solar field applications.
- Rated to 650° F (343° C).



Flanged Ends

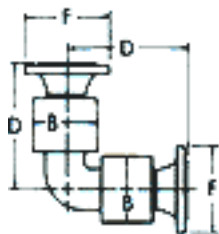

Style 5244

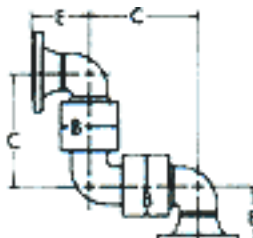

Style 5246

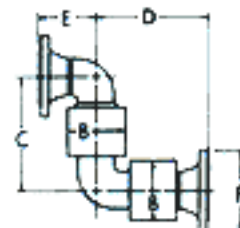

Style 5248

Dimension Data - in./mm

Joint Size	B	C	D	E	F	Pipe Size	Maximum cold working pressure psi(kg/cm ²)
3" 75mm	5.50 140	10.95 278	10.70 272	5.75 146	7.50 191	3 75	275 20
4" 100mm	7.00 178	13.22 336	12.22 310	7.00 178	9.00 229	4 100	275 20
6" 150mm	9.00 229	20.75 528	18.75 476	9.50 241	11.00 279	6 150	275 20